

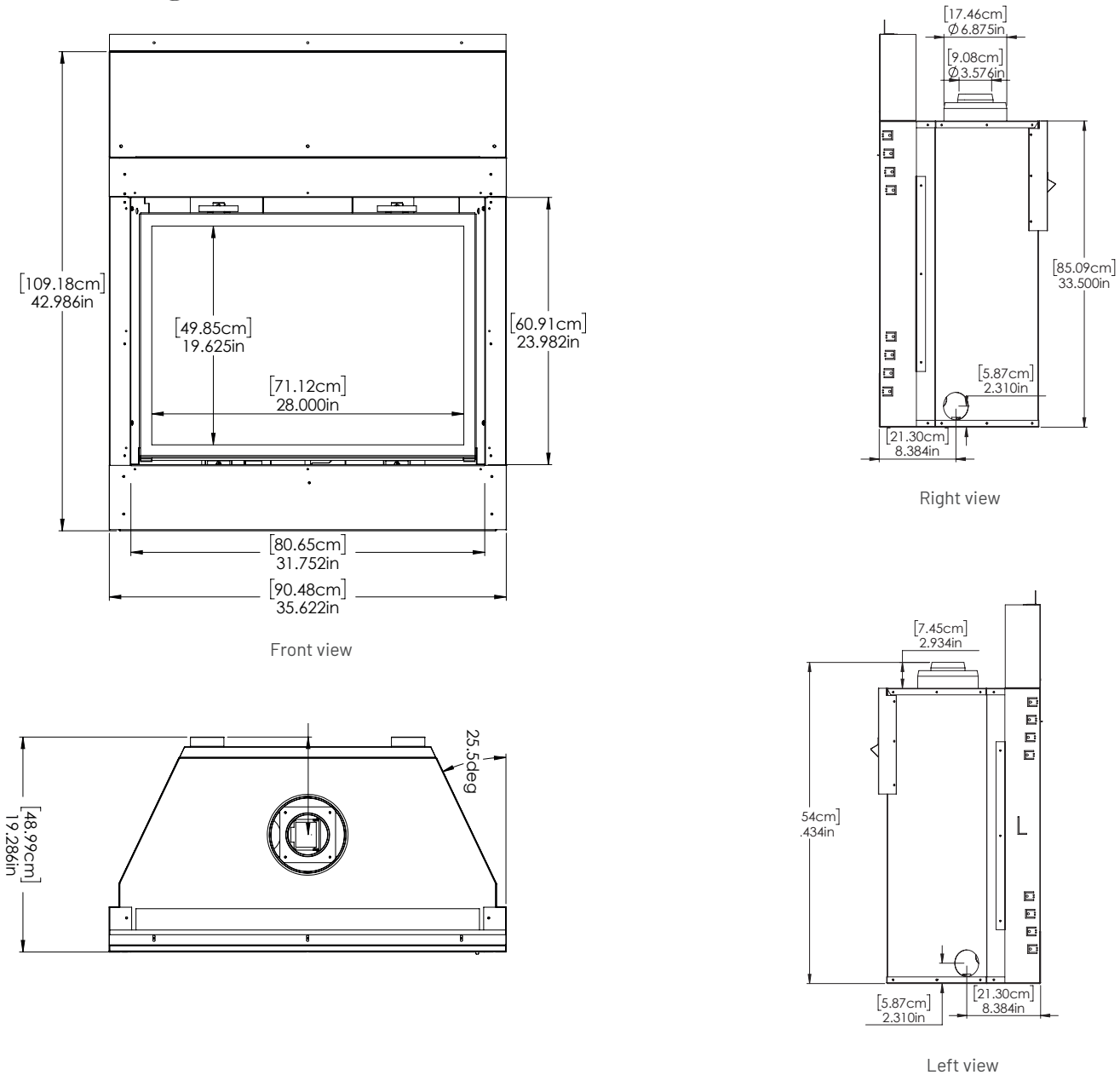

Model: **Intrigue® 36**



BTU				EFFICIENCY		VENTING			GLASS		
Max NG	Max LP	Min NG	Min LP	Energuid	Steady State	Type	Max. Height	In & Out Diameter	Type	Dimensions	Area sq in
27,000	27,000	19,000	21,000	71.13%	75.73%	Direct	35 feet	4" & 7"	Pure vision Robax	28" x 19.63"	550

DIMENSIONS			FRAMING DIMENSIONS			BLOWING		MANTEL SHELF CLEARANCES	
Height	Depth	Width	Height	Depth	Width	Type	CFM	6-inch shelf	
33.5"	19.3"	35.6"	43.25"	18.5"	35.63"	Variable speed	150	18.25"	



Model: Intrigue® 36

Framing and Clearances

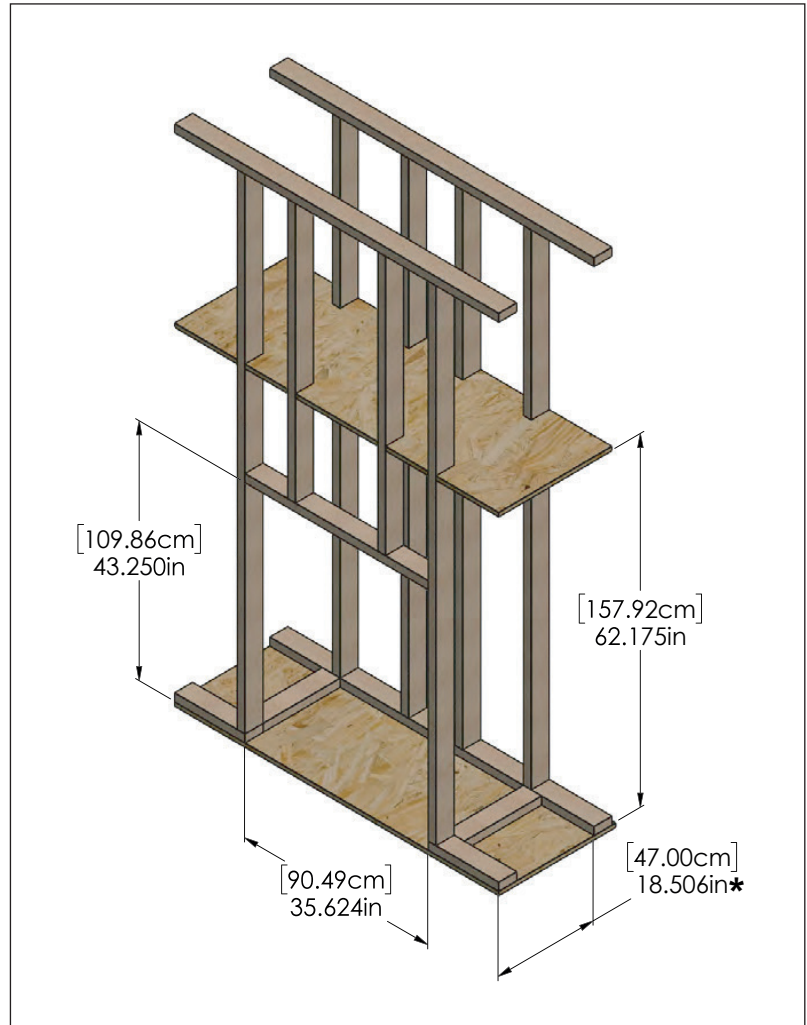

Figure 11.1.01

CLEARANCES

Top of unit face to header (cement board may be used in this area).	10" (254mm)
From unit left & right sides and back	1/2" (13mm)
To flooring	0" (0mm)
Unit top to ceiling	31" (787mm)
Side of unit face to adjacent sidewall	3" (76mm)
Mantel 9" (229mm) deep from top of fireplace	12-1/2" (318mm)
Top of fireplace to 1" (25 mm) trim	10" (254mm)



Model: Intrigue® 36

11.3 Ventilation Framing

Ventilation framing dimensions are based on DuraVent venting components. If other third party venting components are used, refer to the installation instructions from the third party manufacturer for installation information. The following critical dimensions must be maintained regardless of venting manufacturer:

Item	Critical Dimensions
Distance from ceiling to horizontal pipe	4" (10.16 cm)
Thimble framing dimensions	9" (22.86 cm) W x 10" (25.4 cm) H

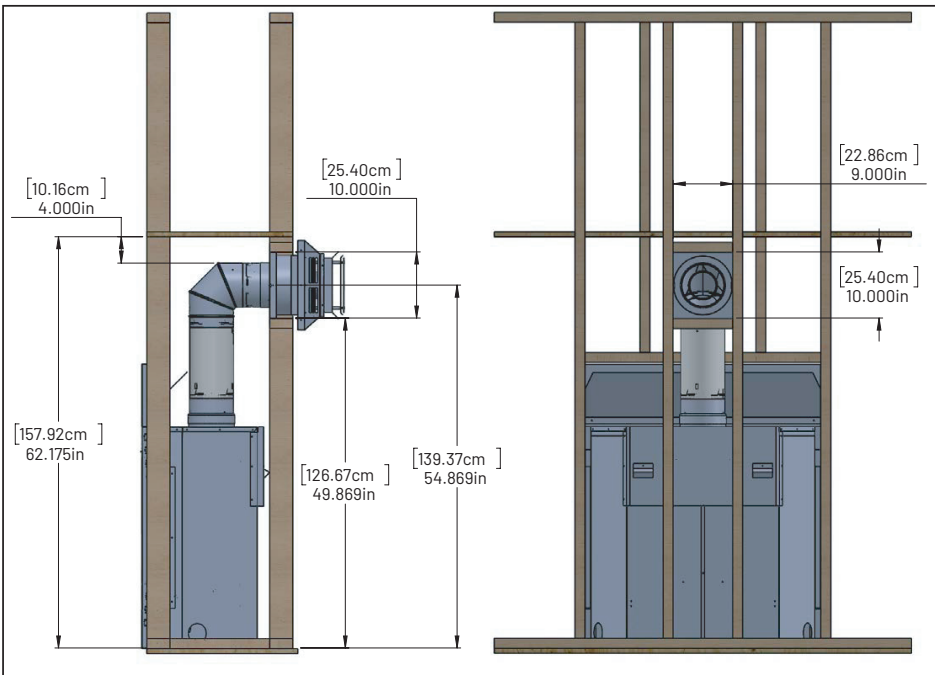

Figure 11.3.01

IMPORTANT

Vent cap location must be in compliance with guidelines in **Section 10.4** of this manual.

WARNING

DO NOT RECESS VENT CAP INTO WALL OR SIDING.

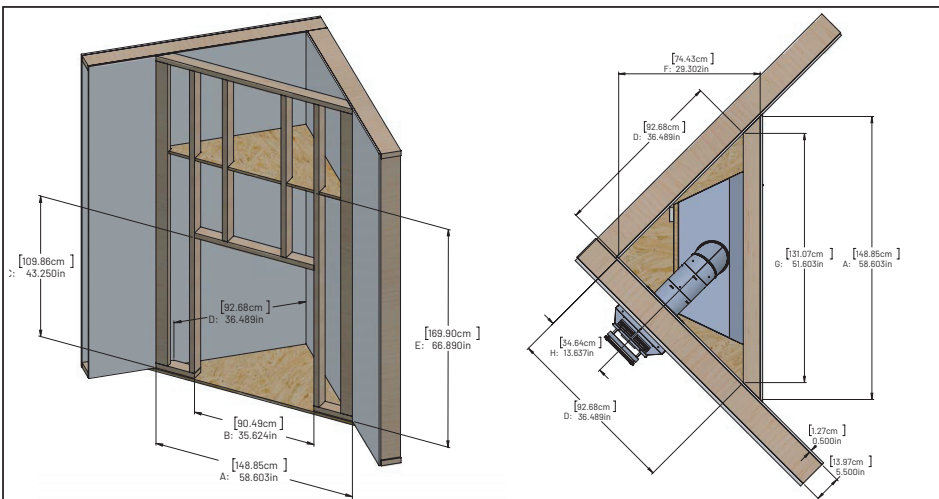

Figure 11.2.01



Model: Intrigue® 36

12.0 Clearances to Combustibles

WARNING: Failure to position the parts in accordance with these diagrams or failure to use only parts specifically approved with this appliance may result in property damage or personal injury or loss of life.

WARNING: TOP NAILING FLANGE EXTENSION MUST BE ASSEMBLED AND ATTACHED TO FIREPLACE. DO NOT REMOVE. TOP NAILING FLANGE EXTENSION IS NOT LOAD BEARING

12.1 Mantel Clearances

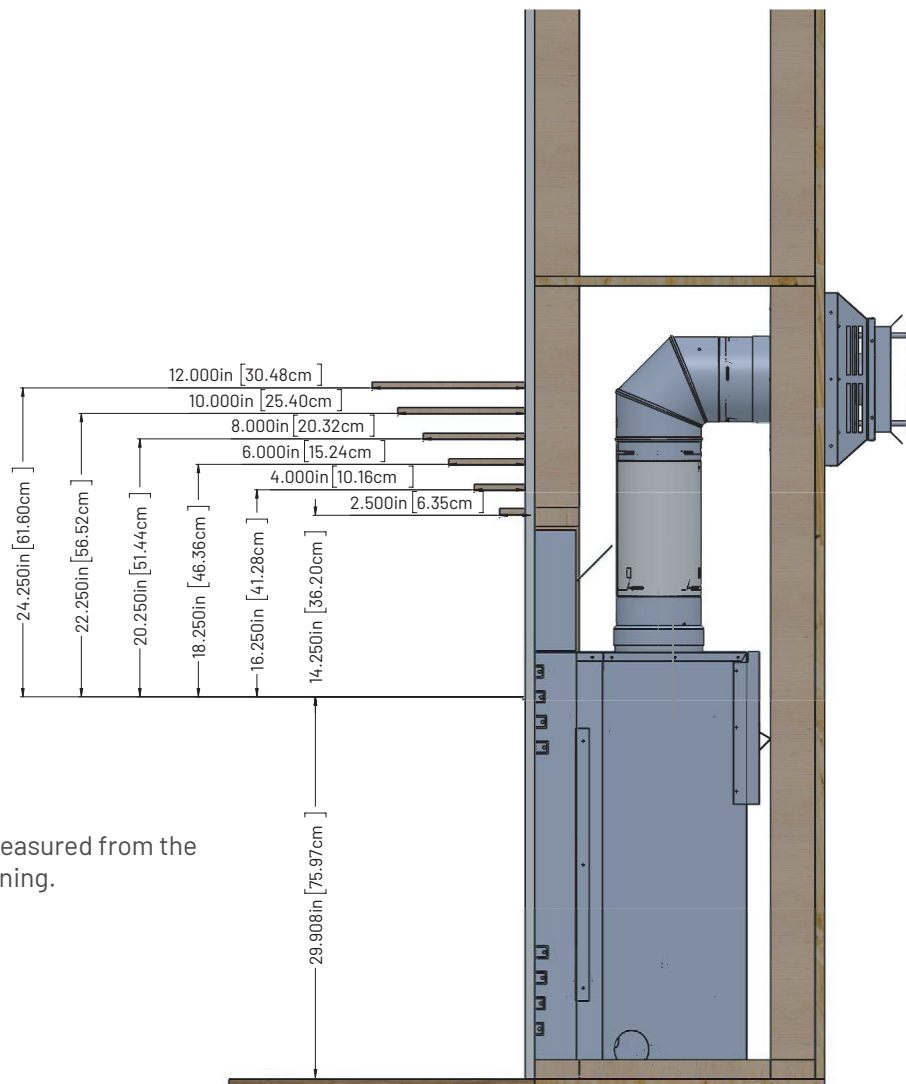

Mantel clearances are measured from the top of the appliance opening.

Figure 12.1.01



Model: **Intrigue® 36**

12.2 Sidewall Clearances

Maintain a minimum of **4" (10.16 mm)** clearance from the side of the glass door to sidewalls or mantel supports.

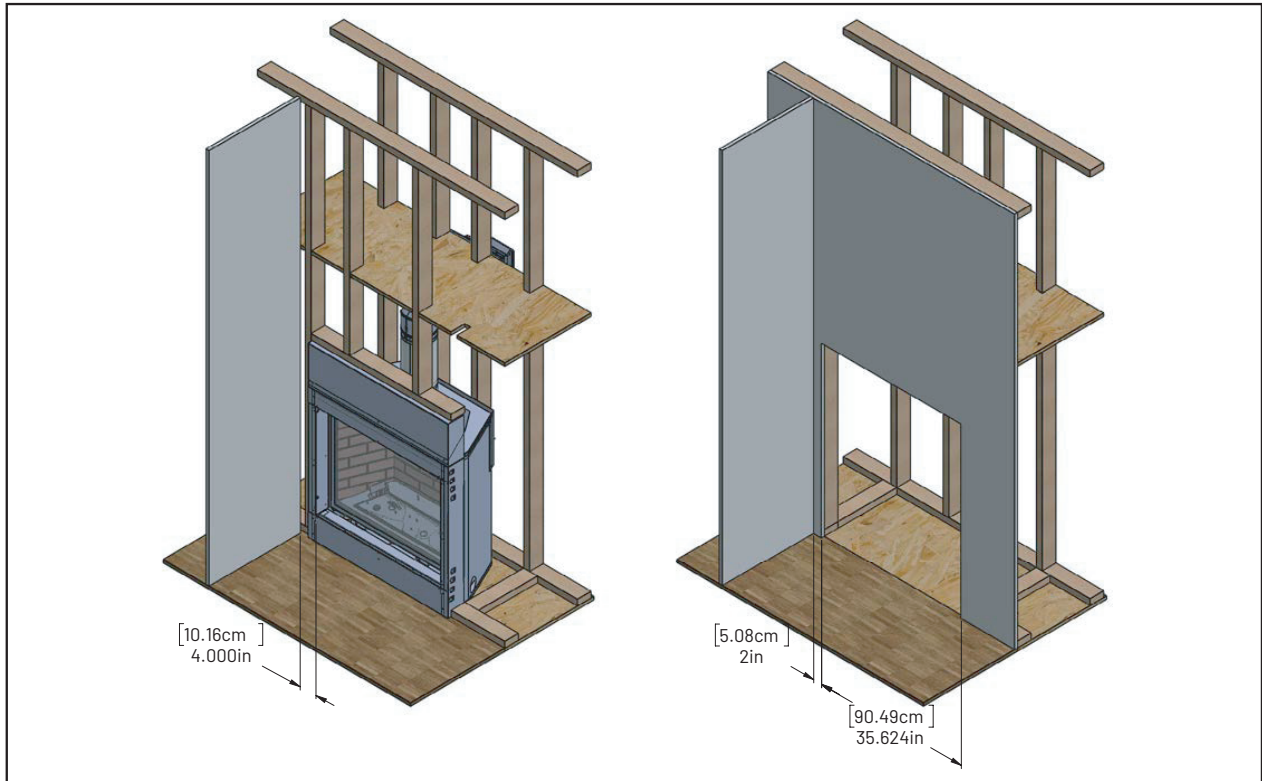

Figure 12.2.01

12.3 Optional Hearth Installation

Any hearth extending 12» or less from the front fireplace must be constructed of non-combustible material. A hearth is not required for installation.

